

# Where Classical Exquisite Meets Modern Luxury

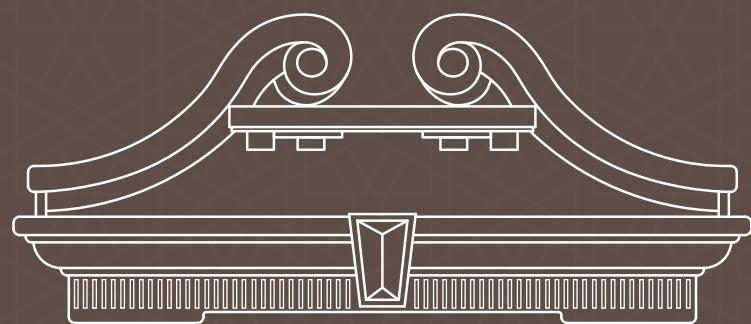





**SREE  
PANCHANAN  
RESIDENCY**

NEO - CLASSICAL LIVING



6, SAHEED NAGAR, BHUBANESWAR







# About the Project

## A Harmonious Fusion of Classical Elegance and Modern Luxury

Inspired by the timeless beauty of Neo-Classical European architecture, Sree Panchanan Residency brings a blend of old-world charm and modern sophistication to Bhubaneswar.

Designed for discerning residents, this exclusive project offers an unmatched lifestyle experience, blending luxury with innovation to create homes that are both beautiful and functional.



NEO-CLASSICAL  
ARCHITECTURE



MODERN  
AMENITIES



PRESTIGIOUS  
DEVELOPER



PRIME  
LOCATION







# An Investment in Legacy

This iconic development is more than a residence; it's a legacy. This prestigious property offers not just a luxurious lifestyle but also a valuable asset that will appreciate over time.

Investing in this timeless address secures a future of elegance, exclusivity, and architectural magnificence – a place you can proudly pass on to the next generation.







# Luxury Living

Crafted for the Discerning

Each residence has been thoughtfully crafted to maximize natural light, ventilation, and space, creating a haven of refined comfort.

With high ceilings, bespoke finishes, and a layout designed to enhance both privacy and luxury, these homes provide a sophisticated lifestyle experience for those who demand the very best.

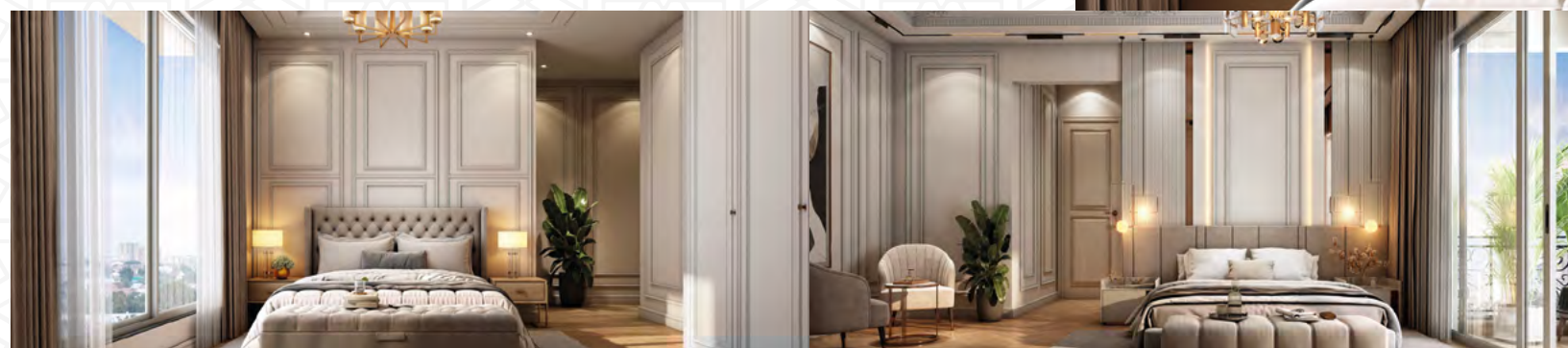





# Lifestyle Amenities

Crafted for Everyday Elegance

Discover a thoughtfully curated selection of amenities designed to elevate your everyday living experience. From spaces that foster relaxation and wellness to areas that encourage community and convenience, every feature has been crafted with meticulous attention to detail. These offerings blend functionality with sophistication, creating an environment that seamlessly balances comfort, luxury, and modern living.

## Grandé Lobby



A Regal Welcome

Step into the Grandé Lobby, an exquisite space that sets the tone for elegance and sophistication. Featuring timeless design elements and luxurious detailing, this central hub welcomes residents and guests with unmatched grandeur, creating an ambiance of refined charm and hospitality.

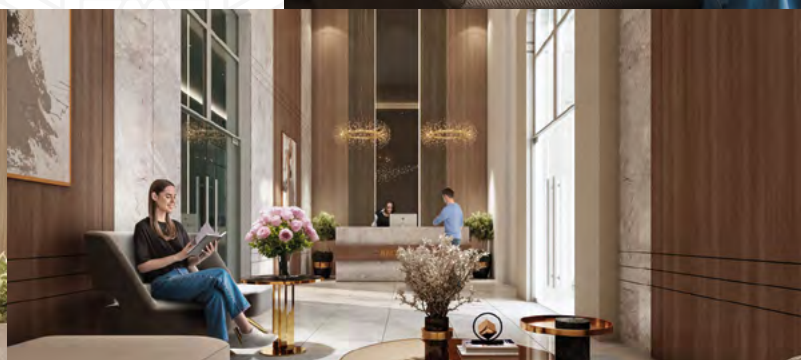
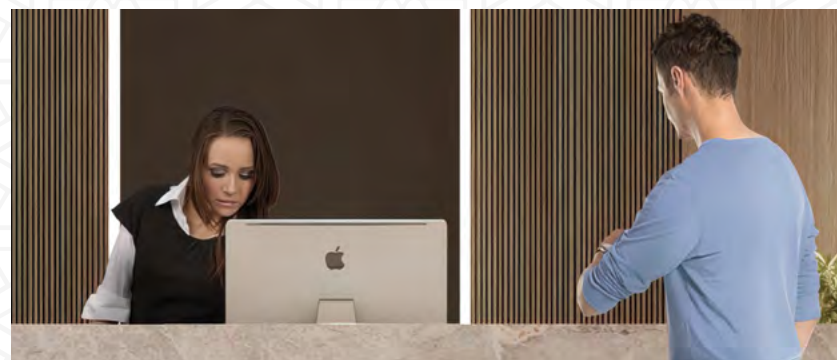





# Vigor Studio

Strength & Vitality

Our fully equipped fitness studio is designed to inspire and support your health journey, with premium equipment and spacious interiors.

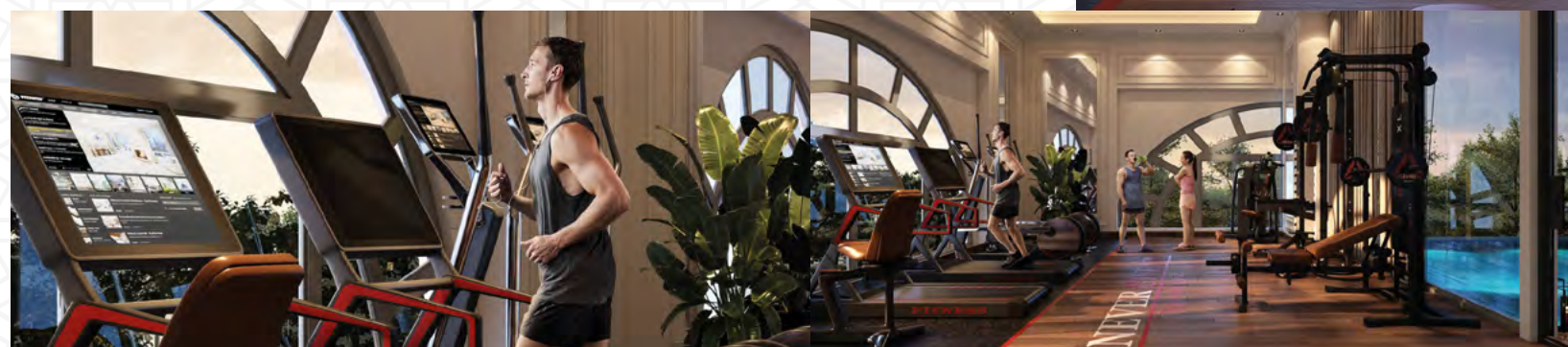





# Union Hall

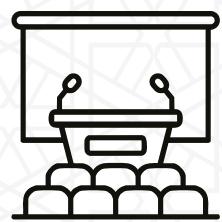

Connect, Celebrate and Create

Union Hall is the heart of community interaction at Sree Panchanan Residency, thoughtfully designed to foster connection and celebration. With spacious interiors and flexible arrangements, this room accommodates a range of activities—from casual meetings to festive celebrations. At Union Hall, residents come together, creating a vibrant and inclusive environment that enriches the community experience.







# Aqua Serene

## Tranquil Swimming

Escape into a serene aquatic oasis with our beautifully designed pool area, perfect for relaxation and unwinding.

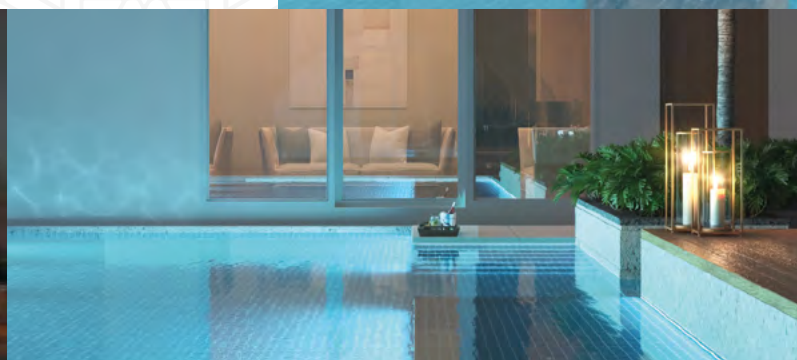





# Vitalia Retreat

Holistic Wellness

A sanctuary for holistic wellness, Vitalia Retreat offers a calm and inspiring space for relaxation, meditation, and personal rejuvenation.

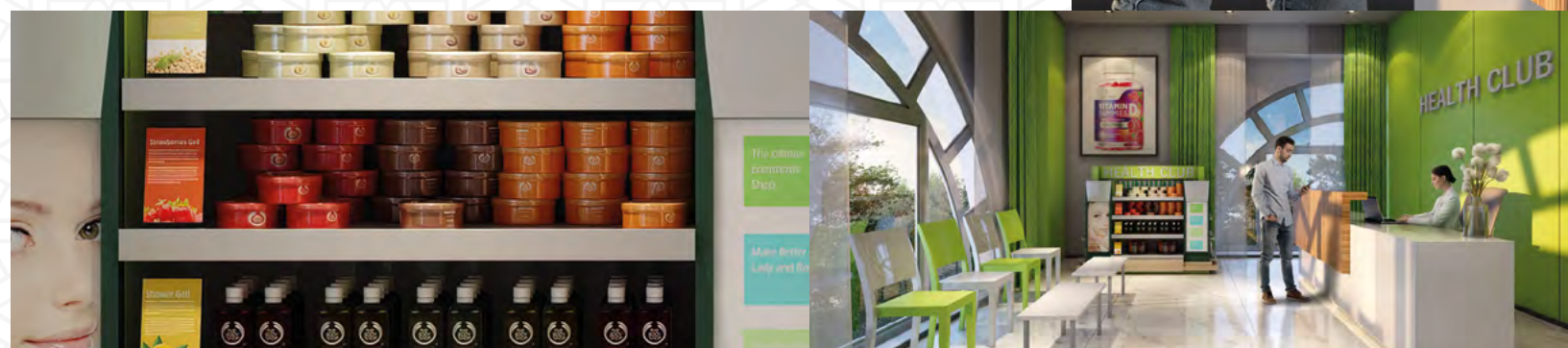





# Cabana



Bask, Relax, Renew

At Cabana, relaxation takes center stage. This exclusive cabana area, bathed in natural sunlight, provides a stylish and serene spot to unwind. Experience the calm of lounging in plush seating with views of the infinite skies and manicured lawns. Cabana is your personal retreat, perfect for a quiet afternoon or an evening spent in elegant leisure.

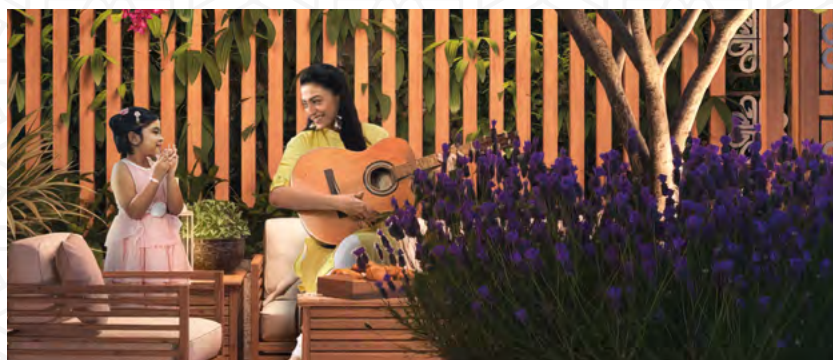





# Terra Verde

## Nature Play Zone

Encouraging outdoor play and exploration, Terra Verde provides a safe, green, and inspiring environment for children to connect with nature.







# Velvet Lounge

## A Chic Retreat for Gatherings

Velvet Lounge is a stylish space designed for intimate gatherings and social get-togethers. With its refined decor and cozy seating, it creates the perfect ambiance for memorable moments.







# Yoga Lawn



## Balance in Every Breath

A beautifully landscaped yoga lawn designed for rejuvenation and mindful practice. Surrounded by lush greenery, this dedicated space invites you to escape the day's bustle and find harmony through yoga and meditation. Whether you're seeking a peaceful morning stretch or an evening wind-down, Yoga Lawn is a sanctuary that nurtures both body and soul.

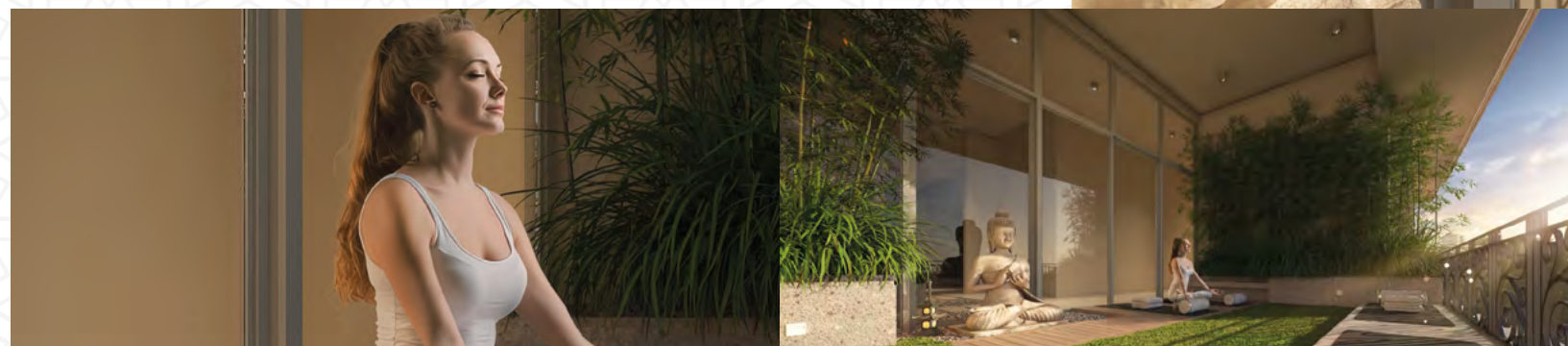





# Petit Castle

## A World of Wonder for Little Ones

Petit Castle is a delightful haven crafted especially for young explorers. With careful attention to safety and comfort, this space offers an engaging environment where children can play, learn, and socialize. Designed to spark creativity and curiosity, it ensures that every moment here is filled with joy, giving parents peace of mind and children a safe, enchanting world to call their own.

And that's not all—our lifestyle amenities extend far beyond, offering even more ways to elevate your everyday living experience.







# Spaces That Inspire Your Vision

Step into expansive living areas designed to adapt to your unique tastes and preferences. With thoughtful layouts and ample natural light, each space provides the perfect canvas for you to craft a home that reflects your personal style.

Sree Panchanan Residency offers the flexibility to design interiors that resonate with your individuality, ensuring every corner feels uniquely yours.





# Specifications

## Uncompromised Quality and Design

Every feature in Sree Panchanan Residency has been meticulously planned and executed to meet the highest standards. From top quality flooring, advanced smart-home technology, to high-end fixtures, these residences are crafted for those who appreciate quality and attention to detail.



### Foundation & Super Structure

Duly vetted Structural Plan for Foundation and RCC frame structure with Fly-ash brick walls

### Flooring

|                          |  |
|--------------------------|--|
| All rooms                | Vitrified Design Tile  |
| Staircase/Lobby/Corridor | Combination of Granite and Vitrified Tile & M.S Handrail for Staircase |
| Lift Facade              | Granite / Vitrified Tile   |

### Toilet

|                   |   |
|-------------------|---|
| Flooring          | Matt finished Vitrified Tile                    |
| Wall              | Glazed Vitrified / Ceramic Tile upto roof level |
| CP Fittings       | Reputed Brands                                  |
| Sanitary Fittings | Porcelain sanitary ware of reputed Brand        |
| Others            | Provision of Exhaust fan and Geyser             |

### Wall Finishes

|          |  |
|----------|--|
| Internal | Acrylic putty with Oil bound distemper |
| External | Weather Coat Paint                     |

### Kitchen

|            |  |
|------------|--|
| Flooring   | Vitrified Tile   |
| Wall Tiles | Vitrified / Ceramic tile upto 2ft from top of the Cooking Platform |
| Platform   | Vitrified / Granite Top and S.S Sink                               |
| Others     | Provision of Exhaust fan   |

### Windows

Powder Coated Aluminium / UPVC frame with Glass Panel

### Doors

|                           |  |
|---------------------------|--|
| Main Doors & Hardware     | Decorative Company made Wooden Door shutters   |
| Fittings                  | Hardware fittings and Locks  |
| Internal Doors & Hardware | Masonite / Equivalent company made Flush Door fittings shutters with hardware fittings and Locks |
| Door Frames               | Treated hardwood or equivalent   |

### Water Supply

24 Hour-Water Supply through UGR & OHT of adequate capacity from deep tube well

### Power Back-up

2 KW to each flat from DG supply  
100% back-up for all common area and lift through DGs

### Telephone / Cable TV

TV points for all Bedrooms and Drawing room  
Telephone point for Master Bedroom and Living room  
Intercom facility at Living room

### Lifts

Branded Lifts  
Power Efficient Automatic S.S Passenger Lift / Stretcher Lift

### Electrical Work & Fittings

Cable & Wires of reputed brand with Modular Switches  
Provision for Electric Points for Split A/c in all rooms

### Fire

Fire Fighting System as per N.B.C

### Security

24x7 Security at Gate & Lobby  
CCTV Surveillance in Basement, Entrance Lobby and inside the premises





# Sustainability and Innovation Designed with a Conscience

This property is committed to sustainable and eco-friendly practices. From energy-efficient lighting to rainwater harvesting systems and advanced waste management, it strives to reduce its ecological footprint while offering a lifestyle that is both luxurious and environmentally responsible.

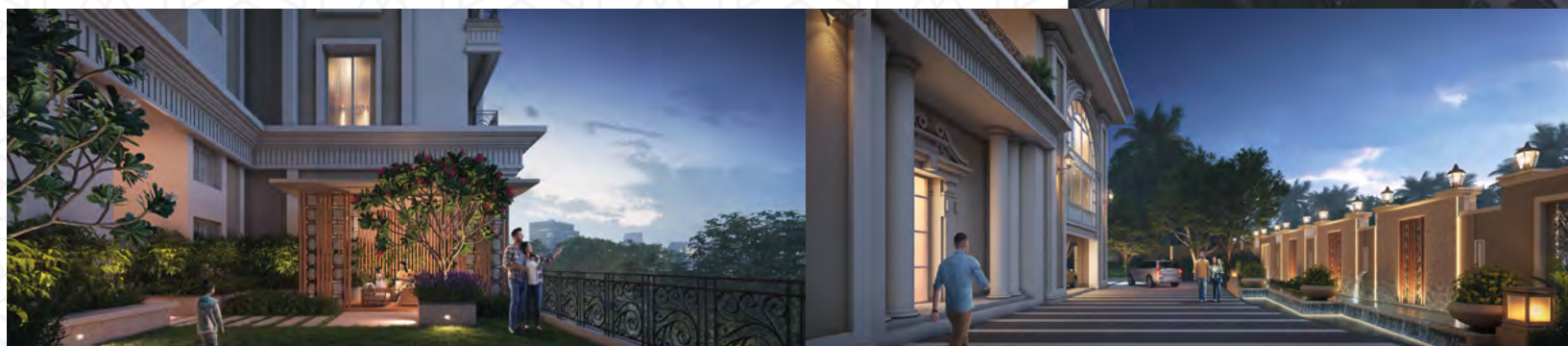





### TRANSPORT

Airport 6 km  
Railway Station 3 km  
Bus Terminal 4 km  
Upcoming Metro 1 km



### HOSPITALS

Utkal 6 km  
Kalinga 4 km  
Care 4 km  
AIIMS 10 km

### EDUCATION

Utkal Uni 500m  
DPS School 9 km  
Sai Int'l 6 km  
KIIT 6 km

### LEISURE

IMFA Park 400m  
Esplanade Mall 700m  
Kalinga Stadium 3 km  
Wonderla 24 km

The given distances are approximate, based on Google Maps.

## Prime Location with Unparalleled Connectivity

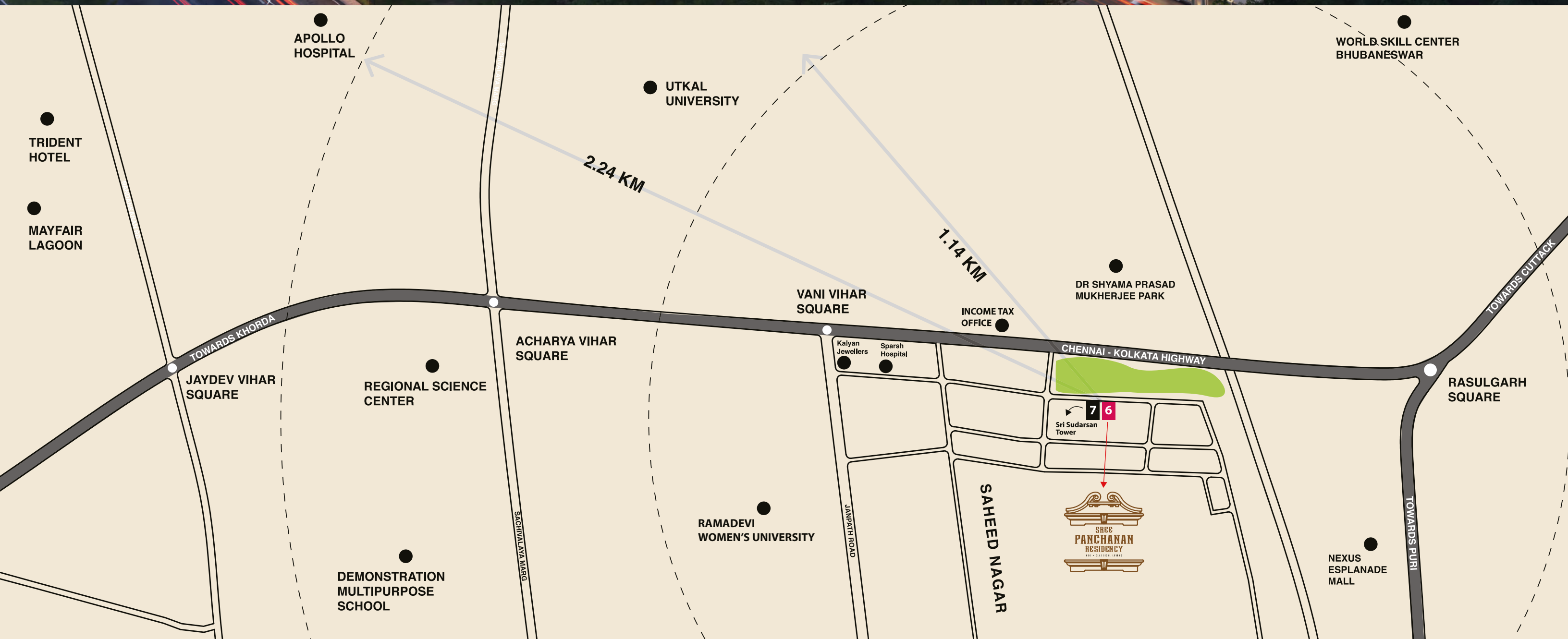





# Typical Floor Plan

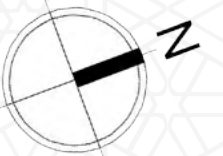

## Flat No 3

|                        |
|------------------------|
| Carpet Area            |
| <b>2056</b>            |
| Exclusive Balcony Area |
| <b>213</b>             |
| External Wall Area     |
| <b>159</b>             |
| SBA                    |
| <b>3532</b>            |



## Flat No 2

|                        |
|------------------------|
| Carpet Area            |
| <b>2071</b>            |
| Exclusive Balcony Area |
| <b>208</b>             |
| External Wall Area     |
| <b>151</b>             |
| SBA                    |
| <b>3560</b>            |



## Flat No 1

|                        |
|------------------------|
| Carpet Area            |
| <b>2081</b>            |
| Exclusive Balcony Area |
| <b>210</b>             |
| External Wall Area     |
| <b>180</b>             |
| SBA                    |
| <b>3568</b>            |

\*All areas in SqFt.





# Site-cum-Podium Floor Plan







# The Legacy of Sri Jagannath Promoters & Builders

Since 1988, the firm has been a cornerstone of real estate development in Odisha. Over the years, it has earned a reputation for delivering exceptional residential projects that combine quality, innovation, customer satisfaction while ensuring compliance to all norms. The firm takes pride in having achieved Occupancy Certificate for all its projects within the stipulated time. With a focus on sustainable development and modern living solutions, it aims to continue leading the way in shaping the city's skyline, offering homes and spaces that are built to last and designed for comfort.

## Landmark projects include:

- \* Shreekhetra Greenwood, Shankarpur - Odisha's first IGBC Gold Certified Residential Project
- \* Shreekhetra Residency, Shankarpur
- \* Shreekhetra Vihar, Aiginia
- \* Sri Sudarsan Tower, Saheed Nagar
- \* Anand Reidency, Saheed Nagar
- \* Neelasaila Villa, Tankapani Road and many more ...



In pictures - 'Shreekhetra Greenwood,' Odisha's first IGBC Gold Certified Residential Project







6, SAHEED NAGAR, BHUBANESWAR

ORERA Regd No. - RP/19/2024/01300 | [www.rera.odisha.gov.in](http://www.rera.odisha.gov.in)

A PREMIUM PROJECT DEVELOPED BY



**SRI JAGANNATH PROMOTERS & BUILDERS**

Plot No 370/3184, Lane next to Toyota Showroom, Sishu Vihar, Patia, Bhubaneswar 751 024, Odisha



+91 8926 1234 02 / 03



[sreepanchananresidency@gmail.com](mailto:sreepanchananresidency@gmail.com)



[www.sjpb.in](http://www.sjpb.in)

ARCHITECT



LANDSCAPE



STRUCTURAL



MEP



MEMBER OF



#### Disclaimer

This brochure is conceptual in nature and does not constitute a legal offering by the firm. It is intended for general informational purposes only. All plans, specifications, artistic renderings, and images presented in this brochure are indicative and subject to change as may be decided by the firm or directed by any competent authority in the best interests of the development. The furniture and furnishings depicted are artist's impressions, provided to illustrate the perspective of the space, and are not included as part of the offering. The sizes, shapes, and positions of openings, ducts, balconies, and landscaping are subject to modification. Room sizes mentioned are structural sizes, and actual sizes may vary due to finishes. Areas provided are approximate and subject to change upon finalization of services and structural designs. Prospective buyers are advised to independently verify all details, including designs, plans, specifications, facilities, features, payment schedules, and terms of sale, with the firm before making any purchase decision. The use of this brochure confirms that the reader has not solely relied on its content for making any booking or purchase decision. This brochure must not be misconstrued as advertising, marketing, booking, selling, or an offer or invitation to purchase a unit in any project by the firm. Nothing contained herein constitutes a legal offering by the company. The information provided may include technical inaccuracies or typographical errors. All images, other than actual photographs, are artistic conceptualizations and should not be treated as definitive references. Sree Panchanan Residency is registered with the Odisha Real Estate Regulatory Authority (ORERA) under Project Registration Number RP/19/2024/01300 dated 27/11/2024. The project is being developed, constructed, and marketed by Sri Jagannath Promoters and Builders.